



BISON Innovative Products

Get CEU Credits, Details, & Specifications online at www.bisonip.com

701 Osage Street, Unit 120, Denver, CO 80204 USA
Phone 303.892.0400 Toll Free 800.333.4234 Fax 303.825.5988
EMail info@bisonip.com Web www.bisonip.com

SCREWJACK
Adjustable Pedestals

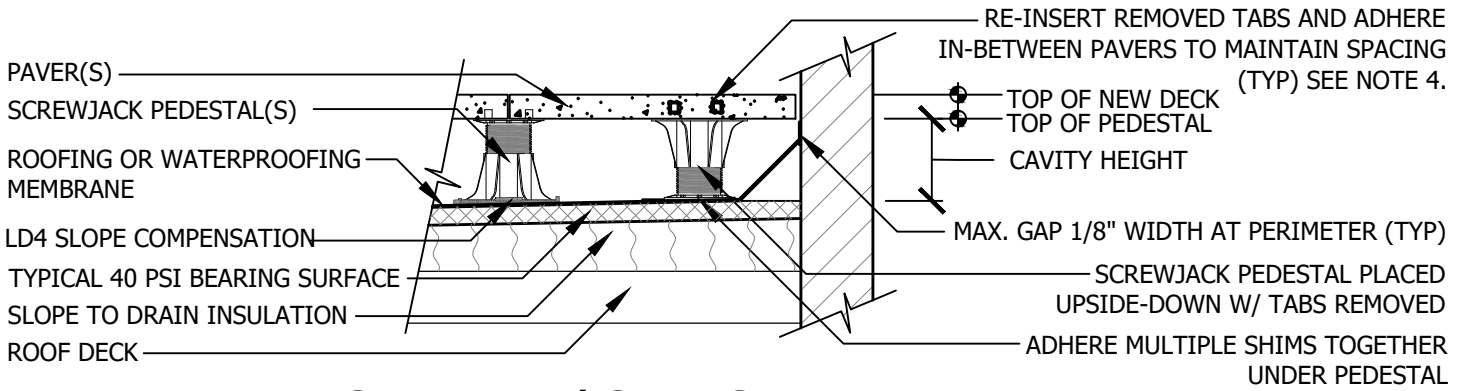

PERIMETER PLACEMENT W/ CANT STRIP

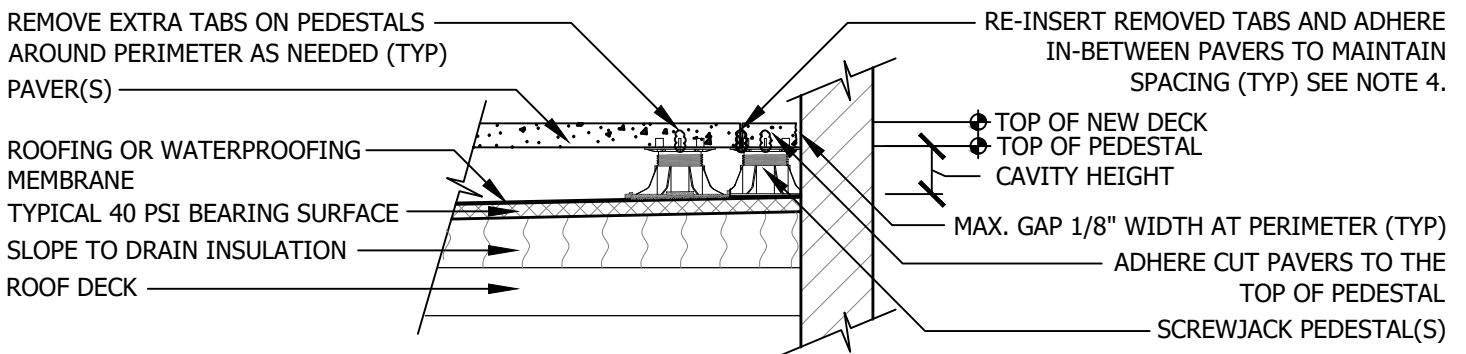

NARROW CUT PAVER PERIMETER PLACEMENT

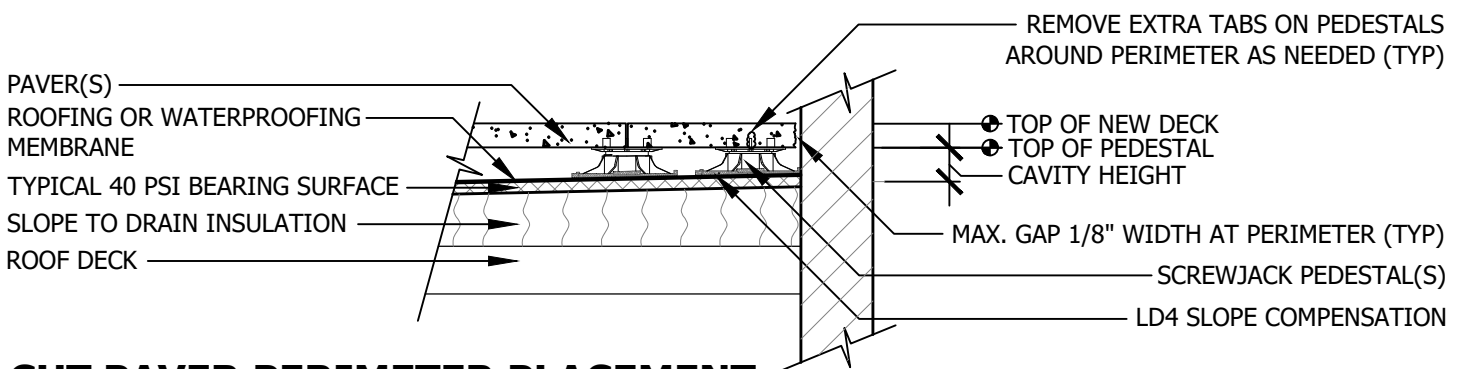

CUT PAVER PERIMETER PLACEMENT

GENERAL NOTES: APPLY TO ALL OF THE ABOVE PRODUCTS

1. INSTALLATION MUST BE COMPLETED IN ACCORDANCE WITH BISON INNOVATIVE PRODUCTS SPECIFICATIONS.
2. DRAWINGS NOT TO SCALE.
3. CONTRACTOR'S NOTE: FOR PRODUCT AND COMPANY INFORMATION VISIT www.BisonIP.com
4. "ADHERE" - INSTALLER MUST ADHERE WITH POLYURETHANE CONSTRUCTION ADHESIVE.

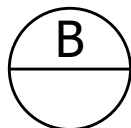

PERIMETER PLACEMENT

CANT STRIP AND CUT PAVER PERIMETER PEDESTAL PLACEMENT